



SERIES VZC, VZD

ESBE
NO.1 IN HYDRONIC SYSTEM CONTROL

Mtrl.nr: 9814 04 79 • Ritn.nr: 9240 utg. B • Rev. 1605



Series VZC151, 161, 152, 162, 253, 263
Series VZD151, 161, 152, 162, 253, 263

CE

LVD 2014/35/EU
EMC 2014/30/EU
RoHS 2011/65/EU
PED 2014/68/EU, article 4.3

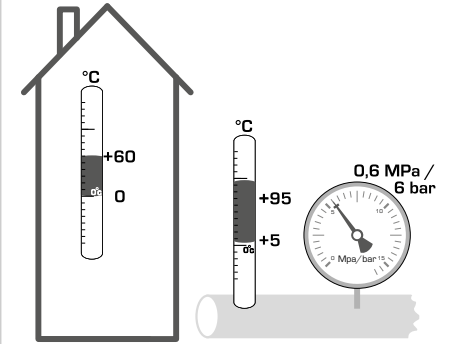

1

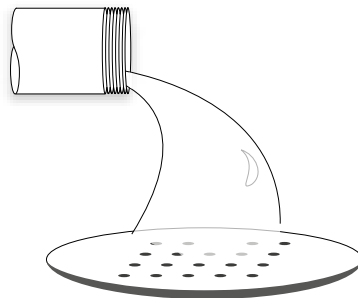
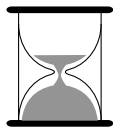
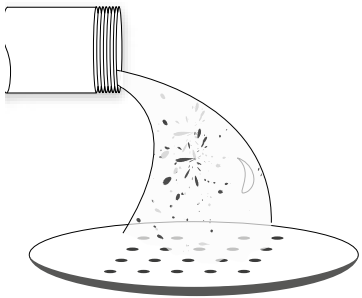

2

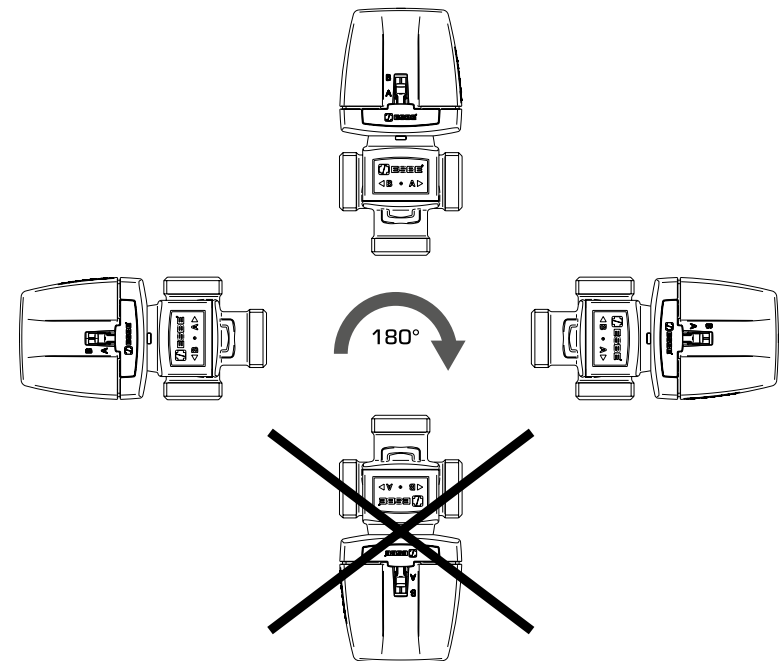

3

VZC151/VZC161, VZD151/VZD161

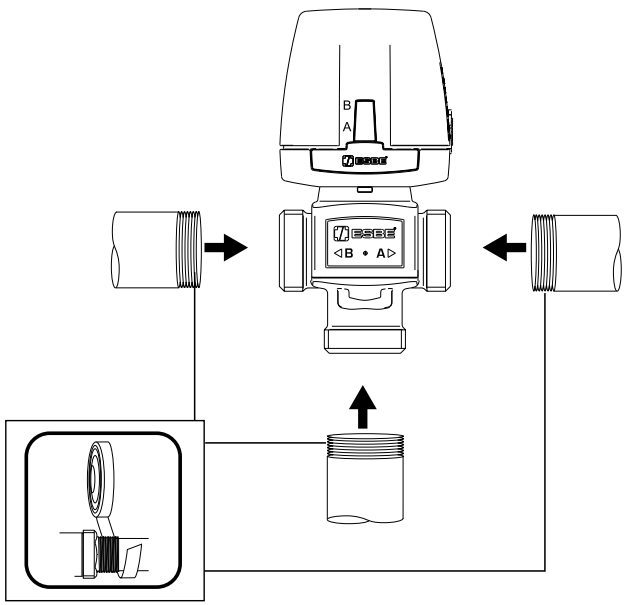

4

i

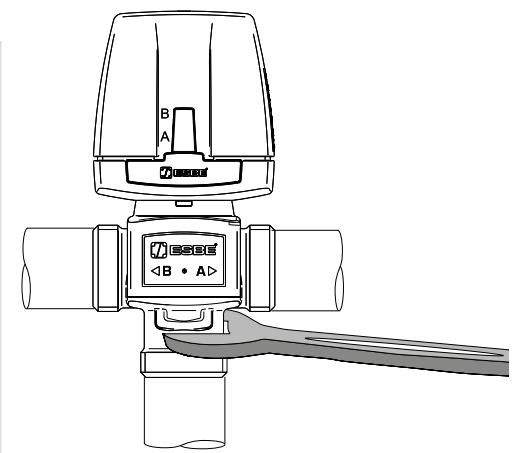
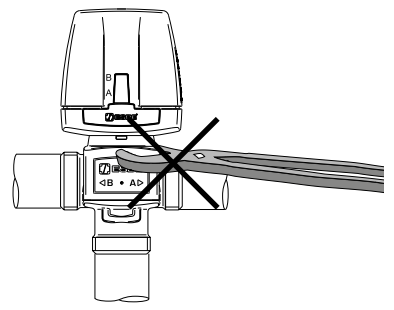

5

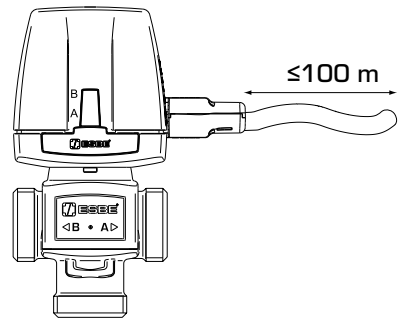
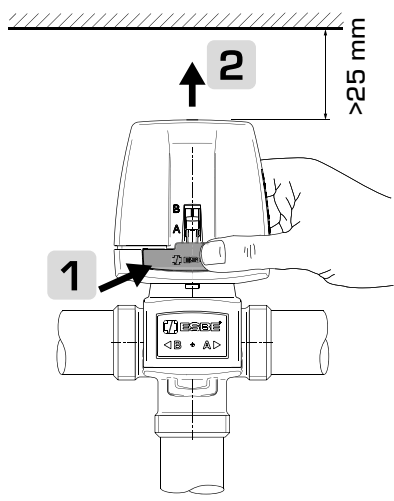
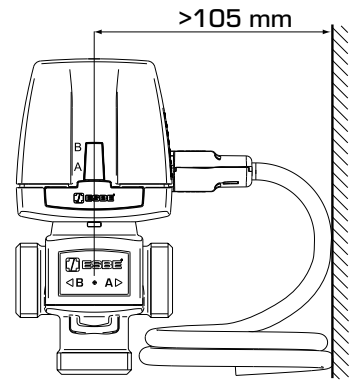

6

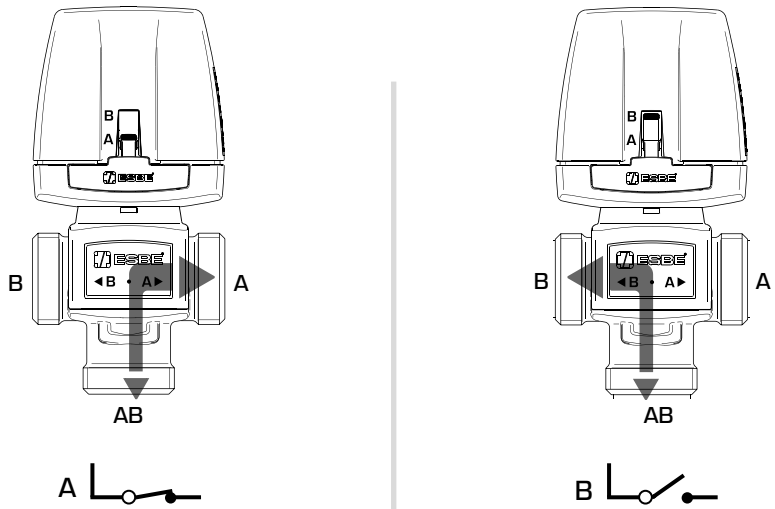

7

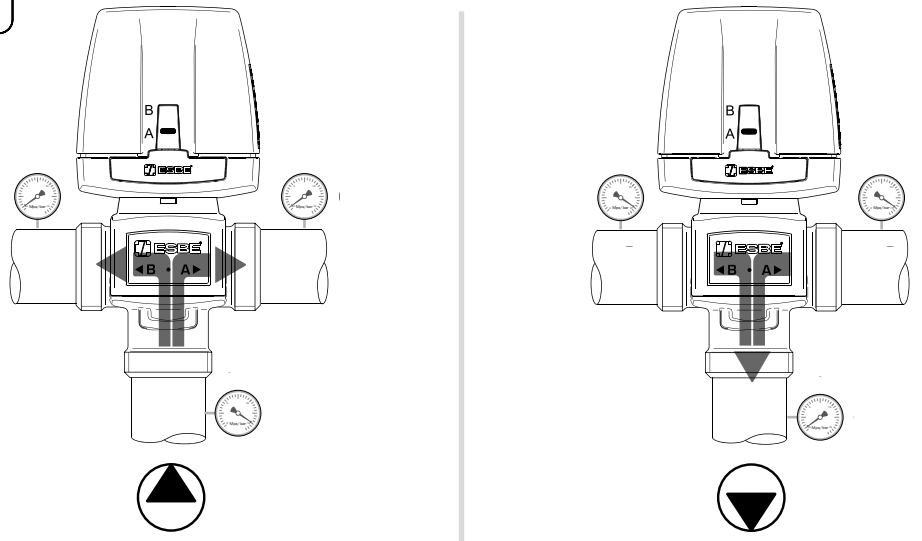

$\Delta P \leq 80 \text{ kPa} / 0,8 \text{ bar}$

$\Delta P \leq 50 \text{ kPa} / 0,5 \text{ bar}$

8

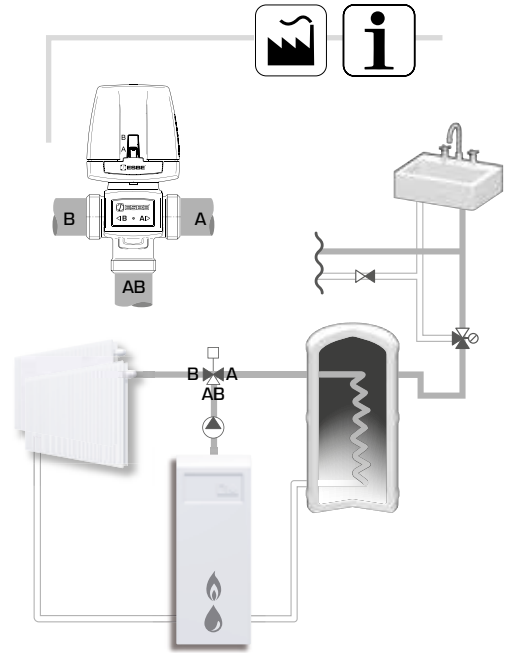

9

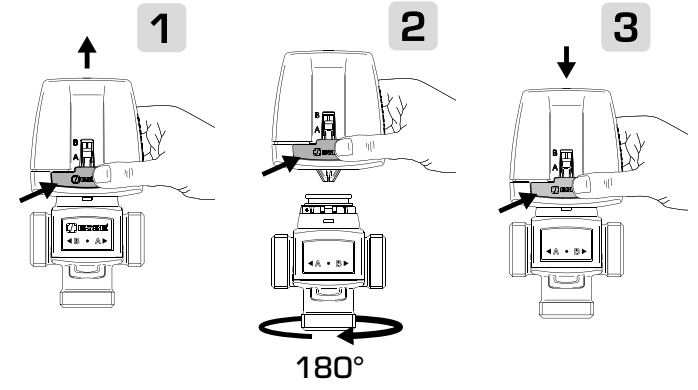
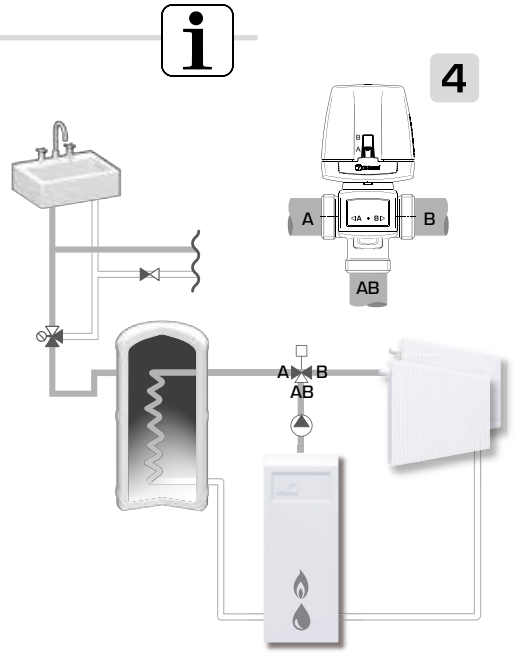

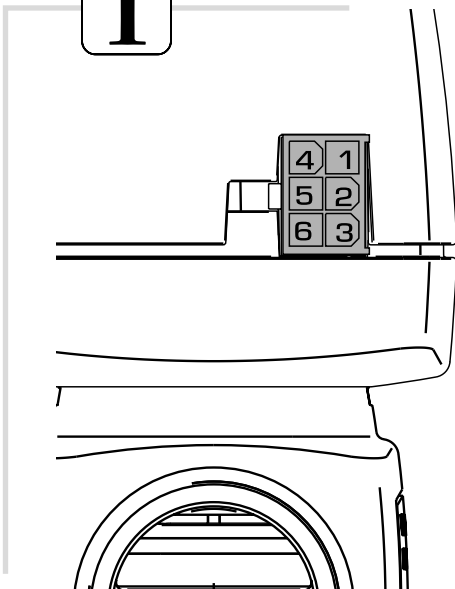
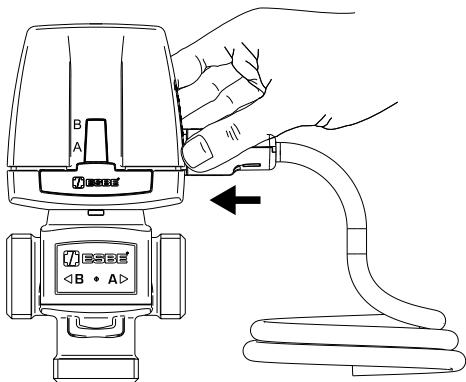
10**i****11**
VZC/VZD 151, 152, 253 — VZC/VZD 161, 162, 263

230 VAC, 50Hz

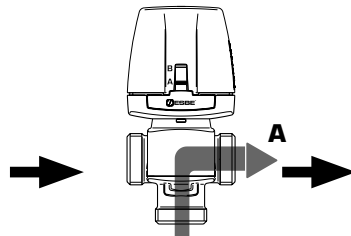
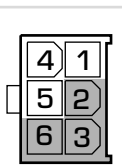
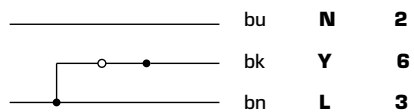
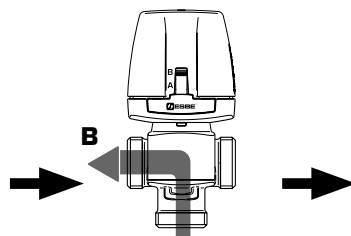
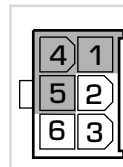
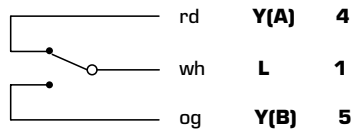
VZC/VZD 151, 152, 253
 $\frac{2[1]}{250}$ A ~ 250 V

 $\frac{2[1]}{250}$ A ~ 250 V
