

# ESBE SERIES ARA600 Prop

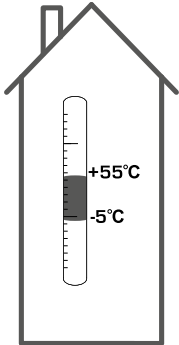

Series ARA639  
Series ARA659  
C €

LVD 2006/95/EC  
EMC 89/336/EEC  
RoHS 2002/95/EEC



i



VRG, VRB, VRH

3MG, 4MG



3G, 4G

3F, 4F ≤ DN50

3HG, 4HG, 3H, 4H



BIV

T, TM

VRC160

1

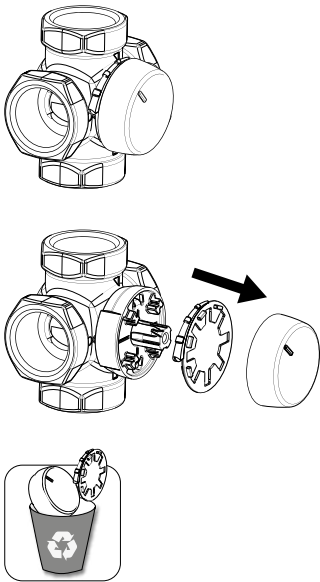

2

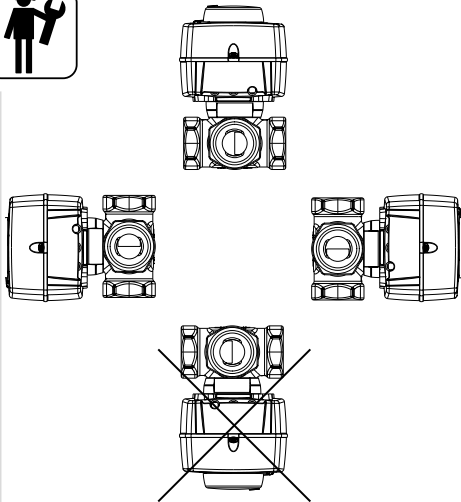

3



Series MG, G, F, H, HG, BIV, T, TM		
	DN15-25	
	DN20-40	
	DN50	
	DN20-25	
	DN32-50	
	H: DN25	
	H: DN32-50	
	HG: DN25	
	DN20-22	
	DN25	
	T: DN20-32	
	TM: DN20	

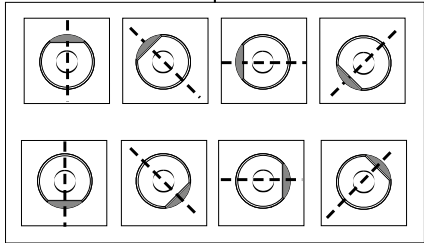
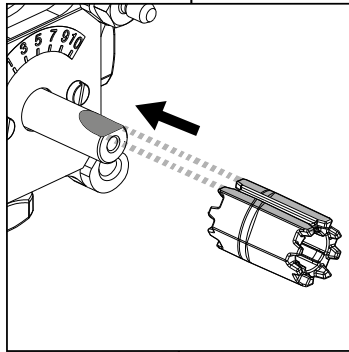
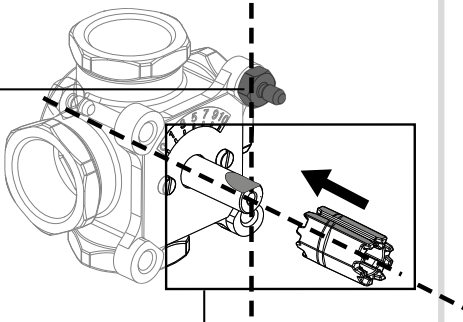

Series **VRGxxx**, **VRBxxx**, **VRHxxx**

Series **VRCxxx**

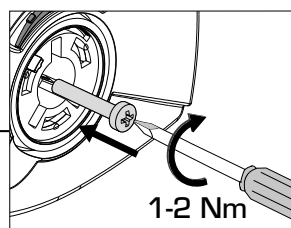
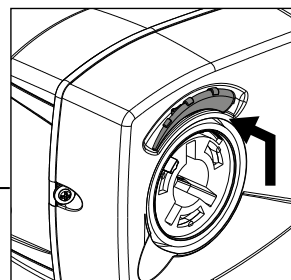
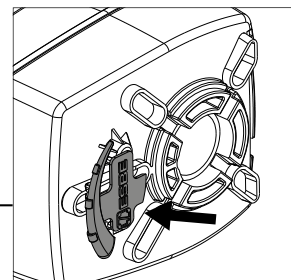
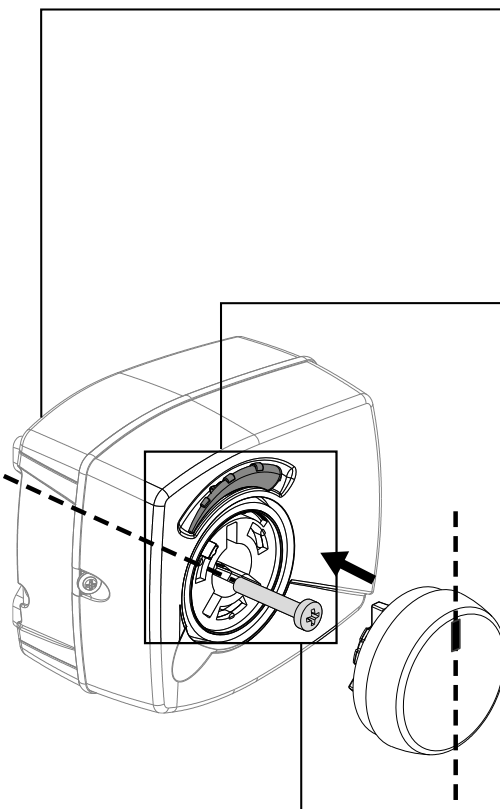
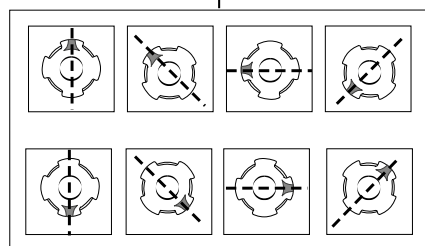
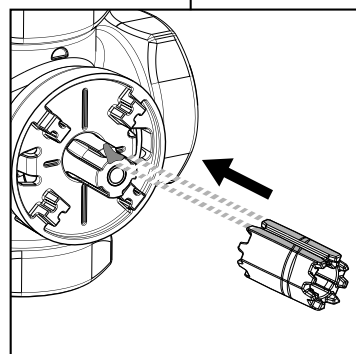
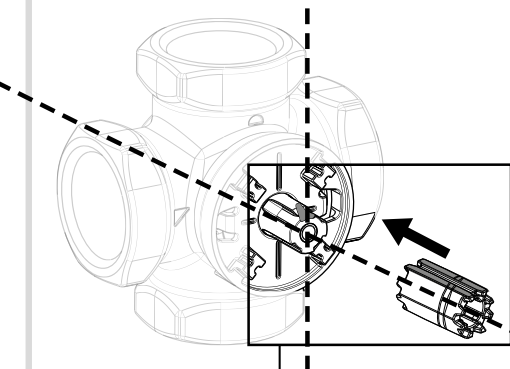

**ESBE®**  
www.esbe.eu

Mtrl.nº: 9814 02 76 • Rlt.nº: 8082 Vers. K • Rev. 1909



**SERIES ARA600 Prop**

**ESBE®**

# SERIES VRG130

**a**

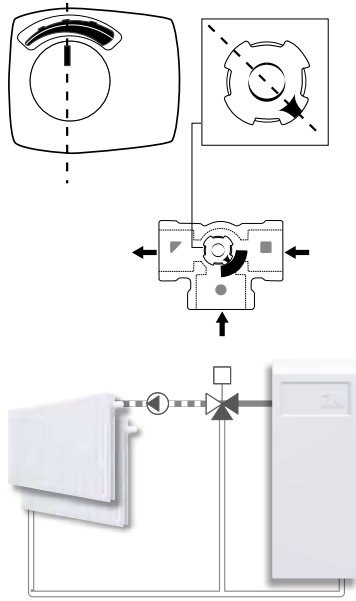

**b**

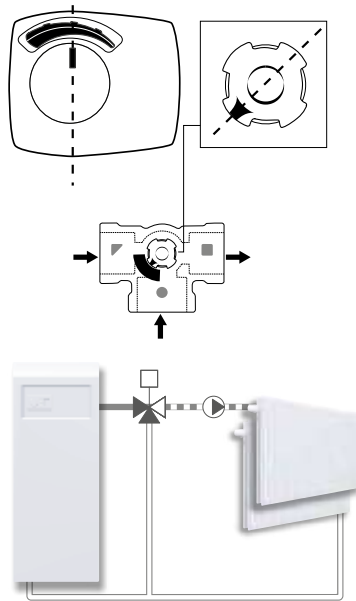

**c**

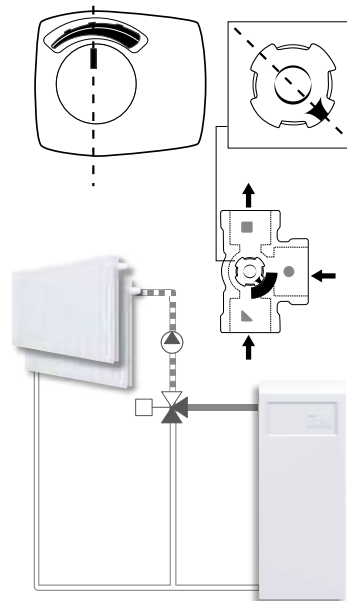

**d**

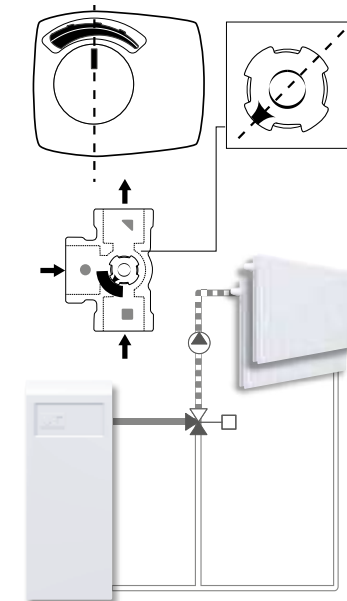

**e**

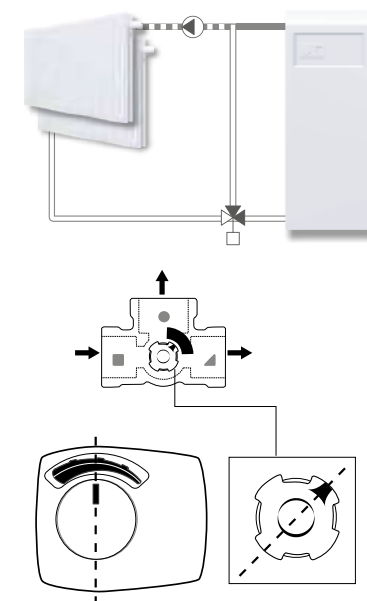

**f**

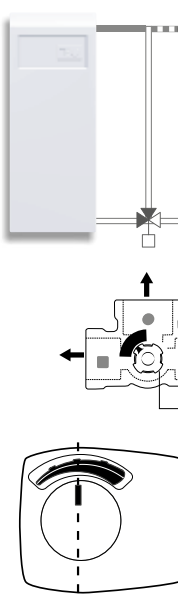

**l**

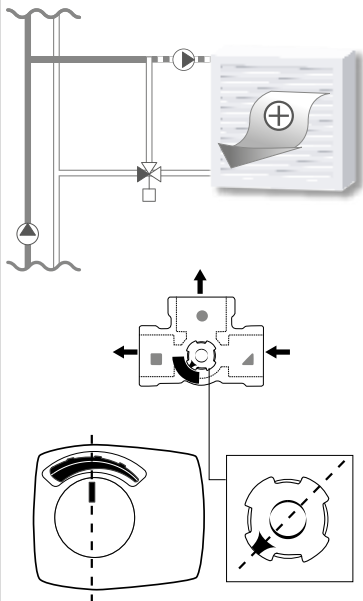

**m**

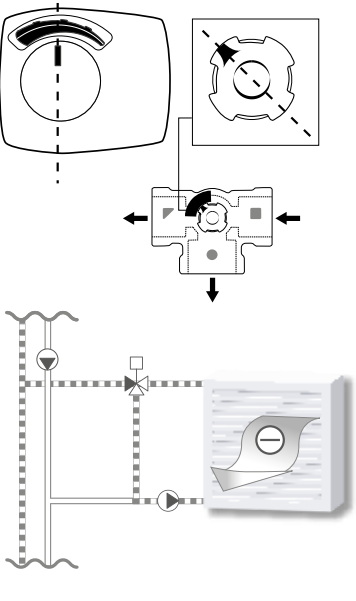

**n**

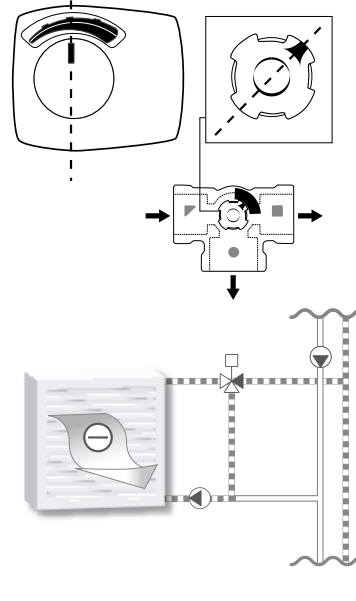

**o**

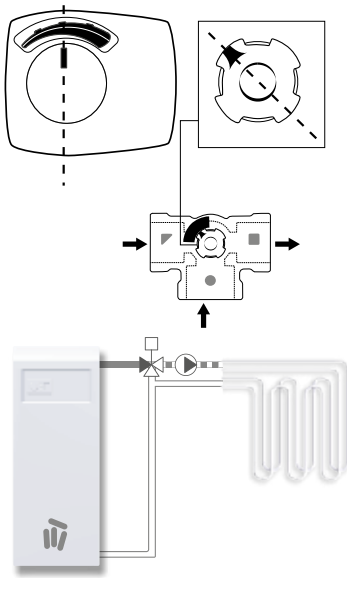

**p**

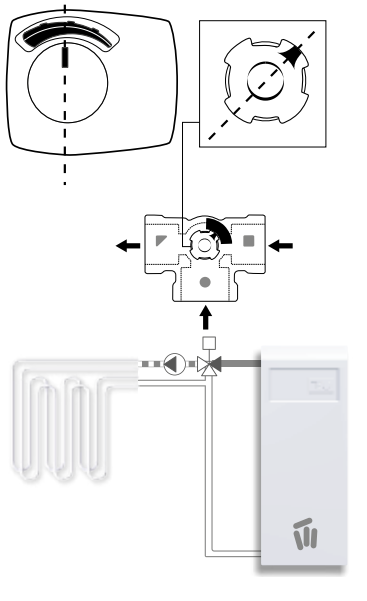

**a**



## SERIES VRG140

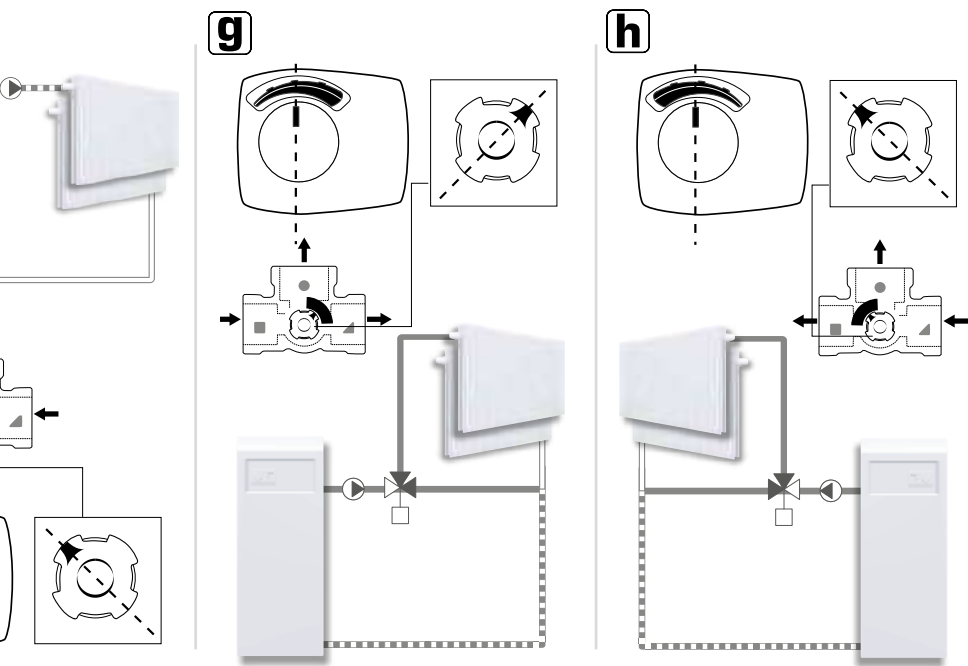
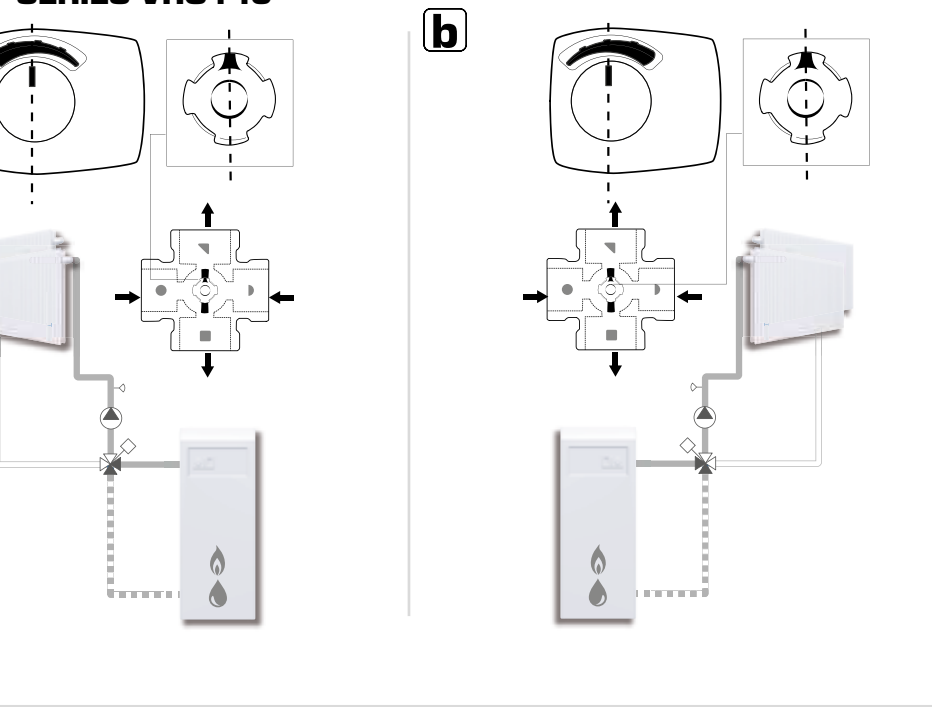

## SERIES VRG230

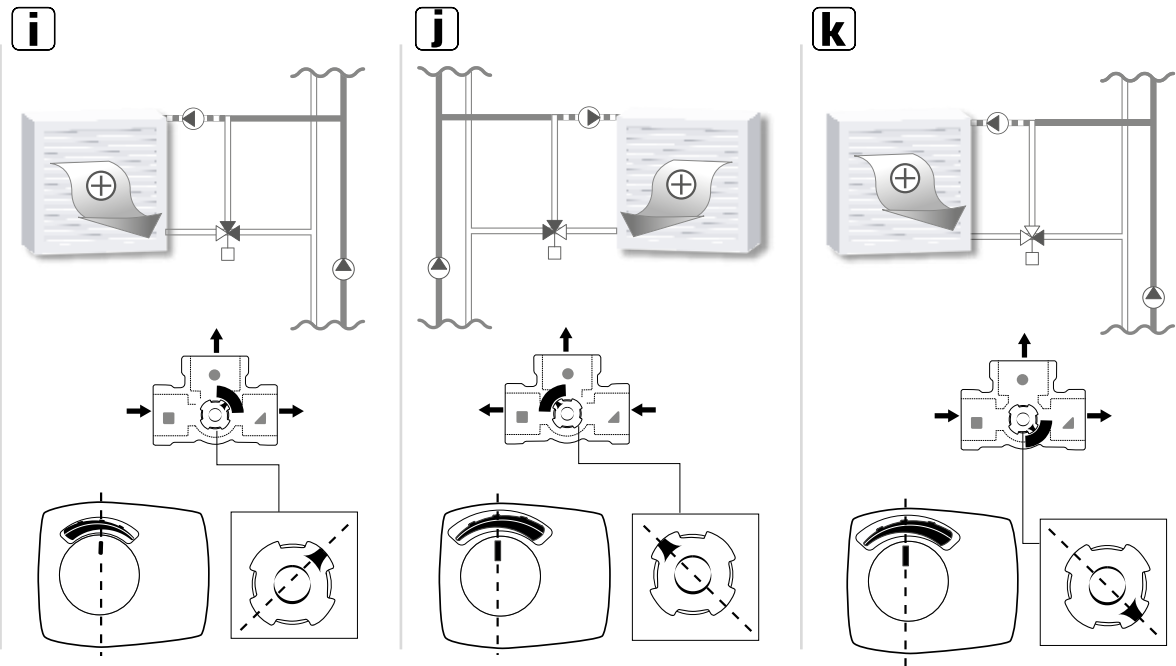
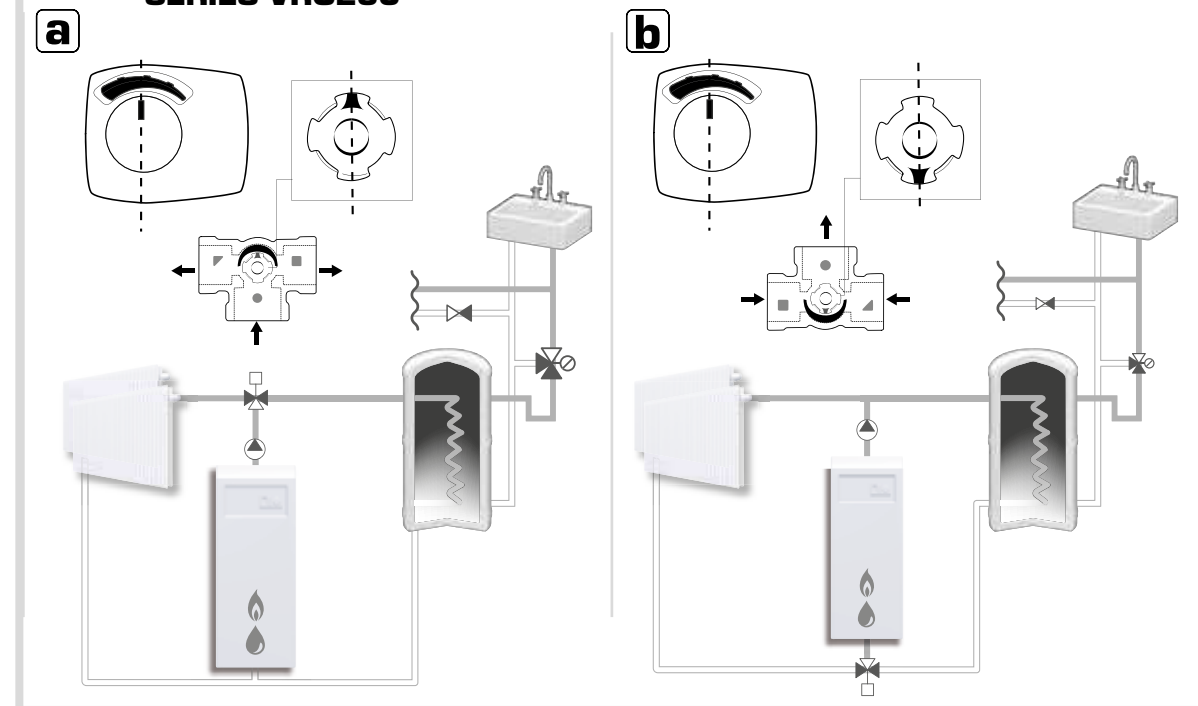

# SERIES VRB140

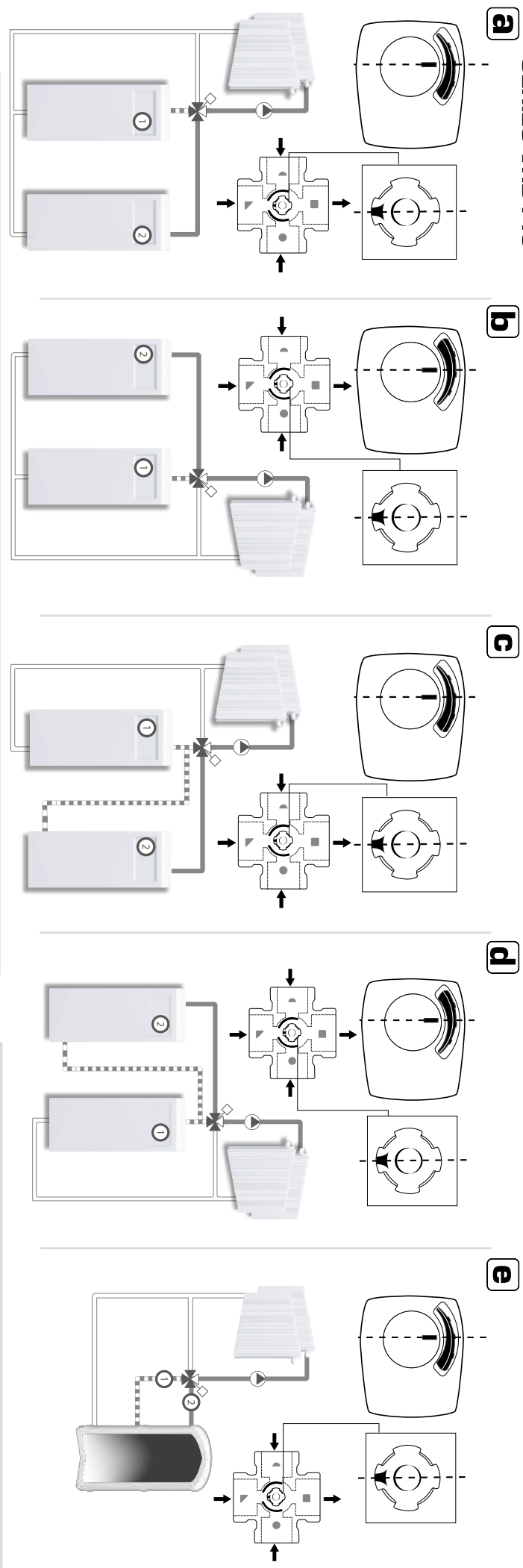

**f**

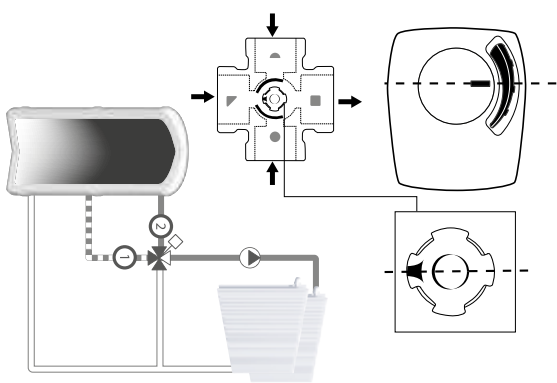

**g**

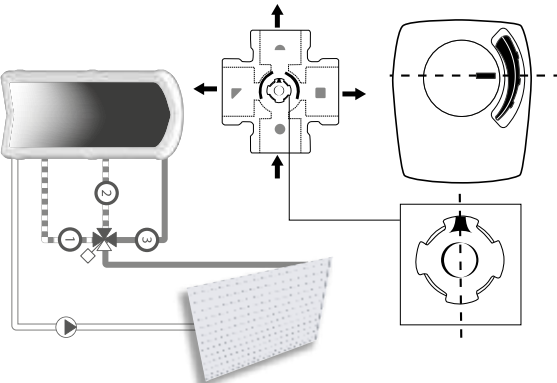

**h**

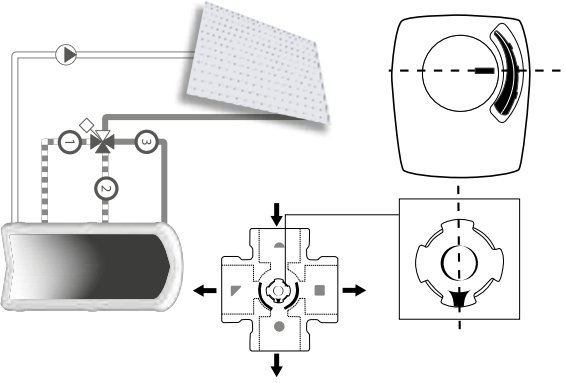

Piping Schematics are General Representations

# SERIES VRC160

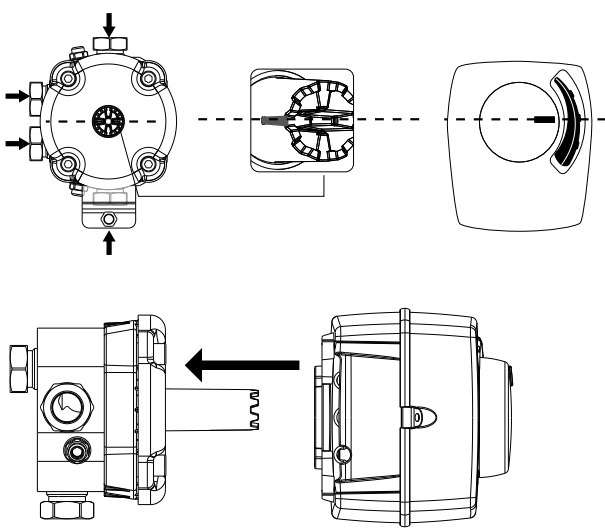

**a**

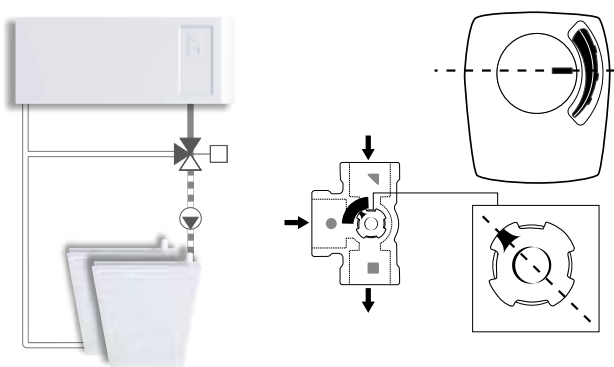

**b**

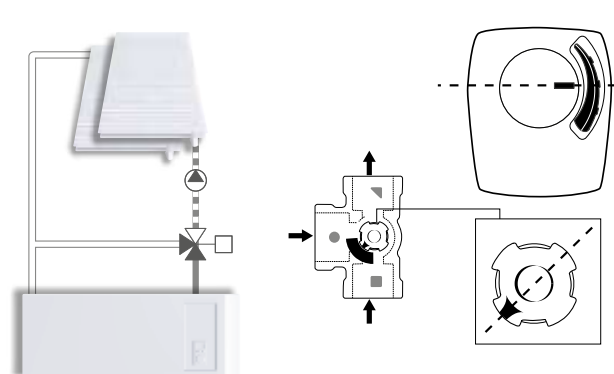

**c**

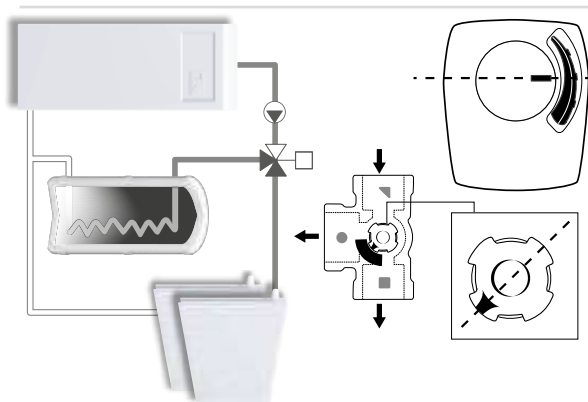

**d**

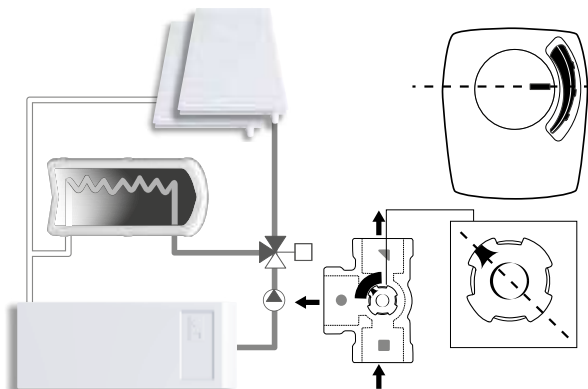

"We would like to pinpoint to the existence of a German patent DE 19821256C5 affecting the usage of bivalent 4-way valves in liquid circulation heating systems. In this patent the usage of a 4-way bivalent valve in a type of heating system is protected, in which 2 different heating circuits are operated in parallel, where the return of the first circuit is utilized as heat source for the parallel second heat circuit. A typical application would be a primary heat circuit with a heat source and a parallel floor heating, where the floor heating in a regulated manner is heated through its heat source and the return from the primary heat circuit is utilized as alternative secondary heat source for the floor heating. Such a utilization of our bivalent 4-way valve without approval of the patent holder is forbidden. All other applications our product group VRB are without restrictions possible."

**4**



**2**

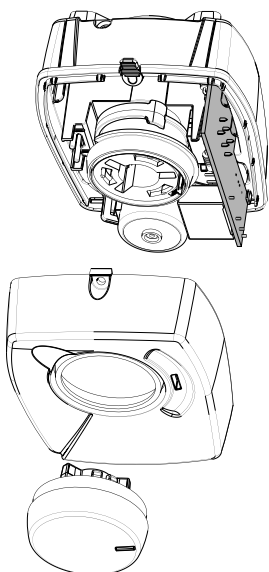
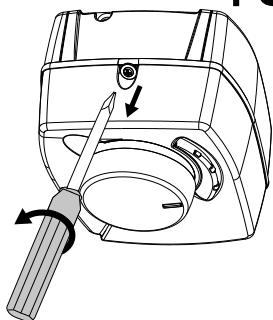



Series ARA639

3/U

3/I

4/U

ON

	120s	60s	30s	15s
1	ON	ON	ON	ON
2	ON	ON	ON	ON

0-10V 0-20mA 2-10V 4-20mA

	ON	ON	ON	ON
3	ON	ON	ON	ON
4	ON	ON	ON	ON

Y

ON

	ON
5	SEQ
6	CW
7	CCW
8	OFF

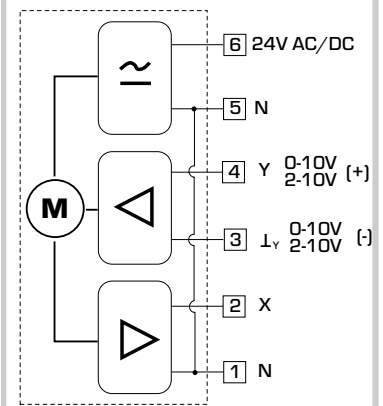
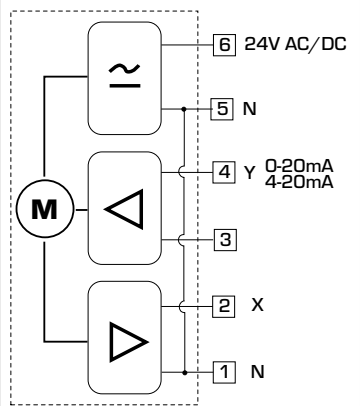
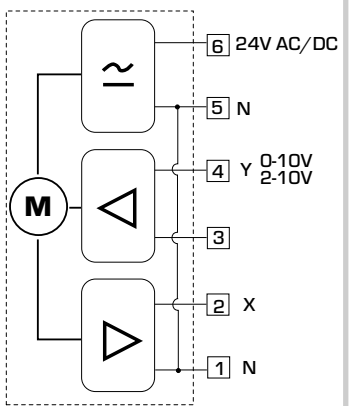

ON

	120s	60s	30s
1	ON	ON	ON
2	ON	ON	ON

OFF

ON

ON

CW

CCW

OFF

OFF

SEQ Cntrl

ON

	120s	60s	30s	15s
1	ON	ON	ON	ON
2	ON	ON	ON	ON

2-10V 4-20mA

	ON	ON
3	ON	ON
4	ON	ON

Y

ON

	ON
5	SEQ
6	CW
7	CCW
8	OFF

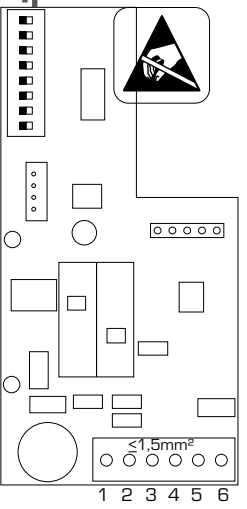
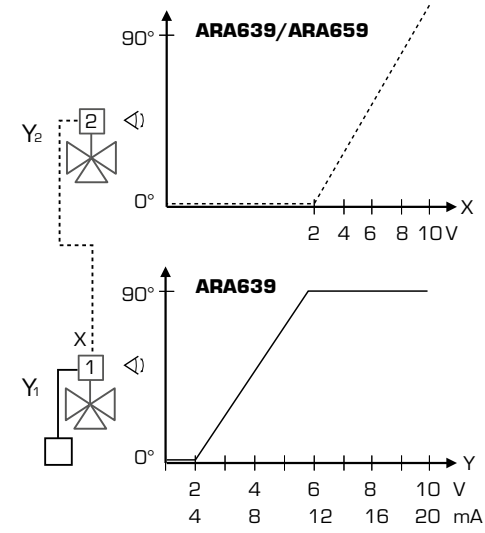
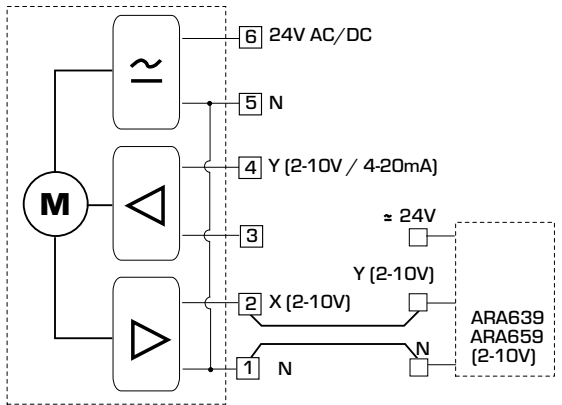

# Series ARA659



3-point

2-point

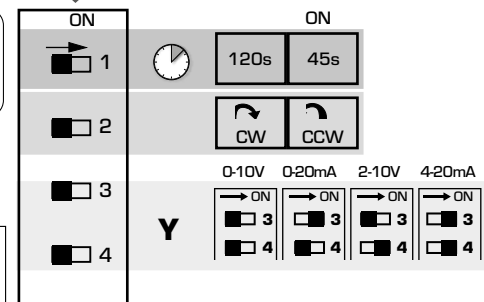
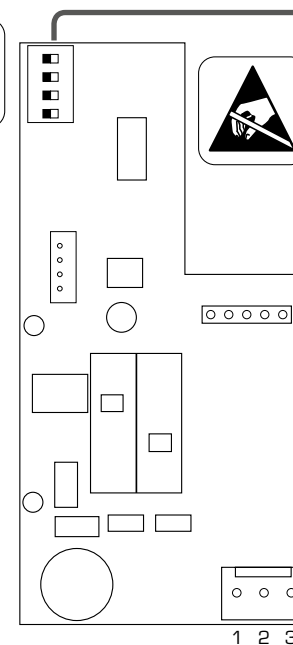
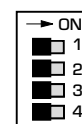
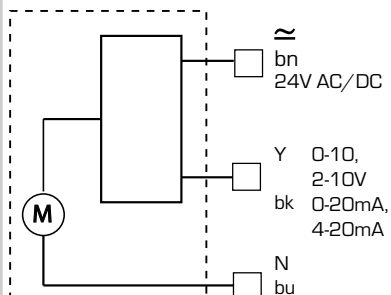
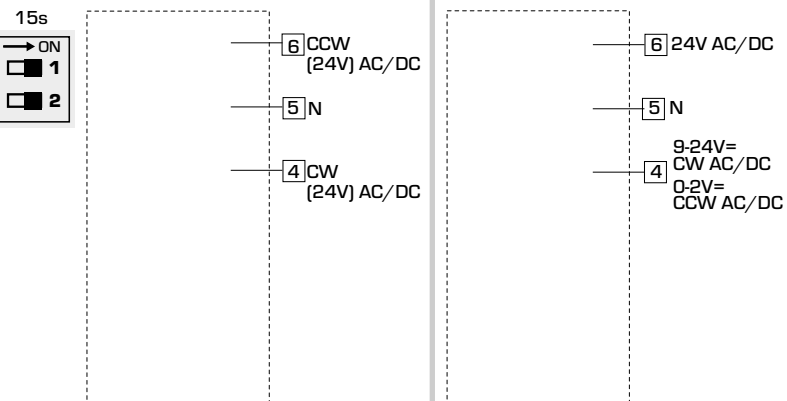

5



1

2

3

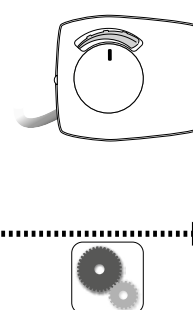
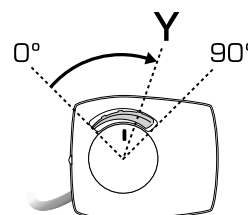
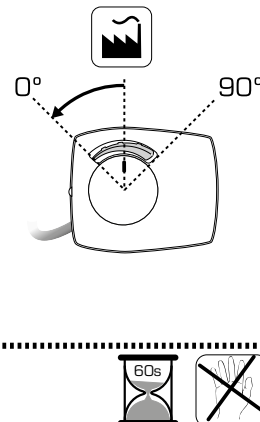
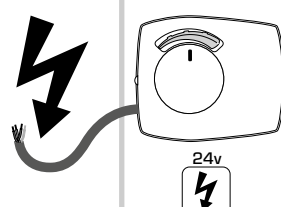
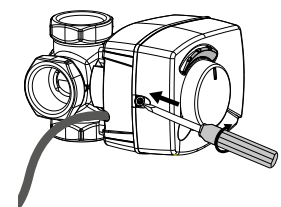

2

1

